



eQuip eDNA sampling system



PATENT PENDING

Quick Start Guide

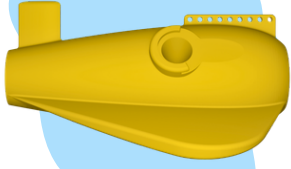

Introducing eQuip sampling device

An underwater eDNA sampling device featuring multiple inlet ports, designed for easy mounting of up to three filter kits. It uses the Venturi effect to generate fluid flow through each inlet while being towed at 4–12 knots.



Introducing filter kit

The kit features uniquely designed filter membrane holder compatible with off-the-shelf 47 mm diameter nylon filters. A tag on the base functions as a handle, enabling easy insertion and retrieval of the filter from both packaging and sampling devices.

Sampling

1 - Attach the device, load the filter and deploy

- Attach a 15–20 m line using provided shackle and ensure it is securely fixed to the vessel
- Wear gloves when handling filters and avoid touching the filter membrane
- Insert the filter into the holder slot and lock it in place by sliding sideways
- Keep the filter storage bag sealed during deployment
- Deploy the device and tow for 5–10 min at 4 to 12 knots

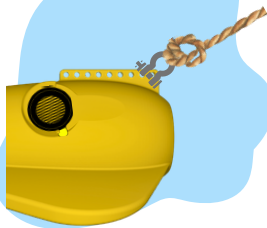

2 - Retrieve the device, store the filter

- Retrieve the device. Holding the tab on the filter base, rotate it and remove the filter, avoiding contact with the membrane
- Shake off excess water from the filter
- Place the filter into the storage bag, ensuring it is pushed fully to the bottom
- Label the storage bag with relevant metadata
- Carefully seal the bag and store at room temperature until processing
- Refer to filter kit information for more details and preservation options.



Decontamination and contamination control

- After sampling remove any visible debris or biological material from the device and the tow line
- Wipe surfaces that may contact water or filters using disposable wipes or wipes lightly soaked in dilute bleach solution ($\leq 2\%$ bleach)
- After bleach cleaning, wipe surfaces with clean freshwater or water from the next sampling site
- Collect at least one field blank per sampling trip, or between stations where contamination risk is elevated
- Prepare a field blank by inserting a filter into the sampling slot and handling it as a regular sample, without deploying the device into the water
- Preserve, store and process the field blanks in the same way as environmental samples

WWW.SEQUENCH.CO.NZ
WWW.SEQUENCH.LT



After use, rinse thoroughly with fresh water



No soaking in bleach or other harsh chemicals

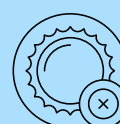

Don't store under direct sunlight